

Notes:
 Do not scale from this drawing. Use figured dimensions in all cases.
 Vary dimensions on site and report any discrepancies to the Architect immediately.
 This drawing is to be read in conjunction with the Architect's Specification.
 © This drawing is copyright and may only be reproduced with the Architect's permission.
Drawing Notes:

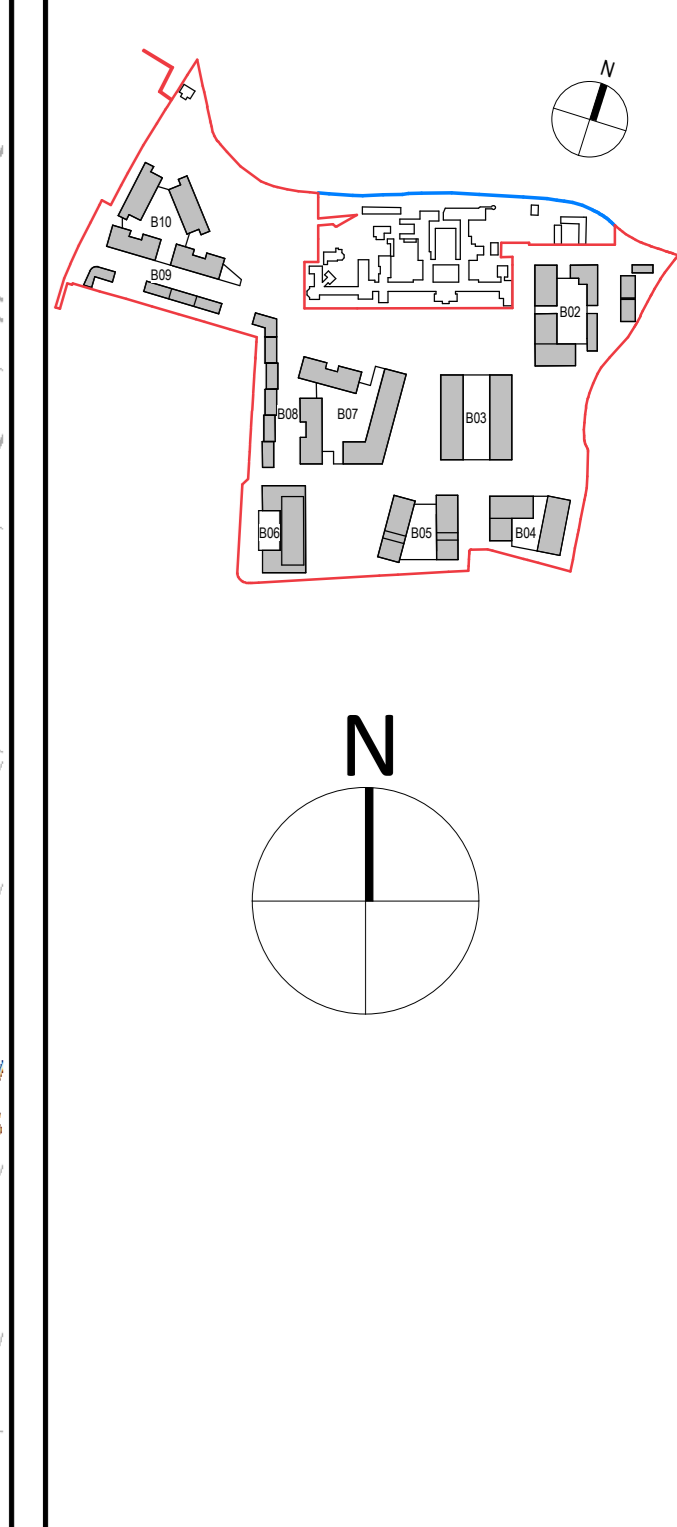

PLANNING LEGEND

SYMBOL	DESCRIPTION
[Red line]	Site Boundary Line
[Blue line]	Site Ownership Line
[Yellow highlight]	Wayleave

OS Licence No.
 CYAL50407200
 © Taithe Eireann – Surveying
Projection / Spatial Reference:
 Projection: IRNET2015 Irish Transverse Mercator
 X: 711742.300532, 720100.30992
Centre Point Coordinates:
 X: 711742.300532, 720100.30992
Reference Index:
 Map Series | Map Sheets
 1:1,000 | 3329-22
 1:1,000 | 3329-02

Rev.	Date	By	Check	Part 10 Planning Application	Details of Issue / Reason
P3.1	Sept 2024	KP		Part 10 Planning Application	Issues & Revisions



Client Details:
 Dun Laoghaire-Rathdown County Council
Agent Details:
 Land Development Agency
Project Details:
 Proposed Part 10 Residential Development,
 Dundrum Central Development,
 Dundrum Road,
 Dublin 14
Drawing Title:
 Site Plan, Proposed
Job No.: P19-233D **Sheet Size:** A0_Landscape **Scale (G.A.):** 1:500
Issue Date: Sept 2024 **Drawn By:** K. Potocka **Reviewed By:** R. Quinn
Status: Purpose of Issue
P3 Part 10 Planning Application
Project System: Spatial Data Level: Type: Original: Role: Number: Revision
DCD-02-SW-ZZZ-DR-RAU-AR-1002 P3-S-1

The existing boundary wall between the site and Rosemount Green is to be removed and the proposed active travel route will be brought to the southern site boundary.
 DLCC will facilitate the extension of the active travel route to Larchfield Road as part of overall improvements to the interface between the subject site and Rosemount Green.